

Technical Details

- Dimensions: 149 x 104 x 85.5mm
- Ports: G1/4"
- LED Mounts: 3 x 5mm

Box Contents

- 1x Dual DDC Bay Reservoir
- 8x Long M4 Screws
- 4x Short M4 Screws
- 4x Drive Bay Screws
- 1x Blanking plate with o-ring
- 2x G1/4" Plugs

G1/4" fittings sold separately



This product is for use with either one or two laing DDC pumps. If you are only using one pump the other two G1/4" ports and the mount for the DDC pump must be sealed off. The dual pump configuration is intended for use with two separate watercooling loops.

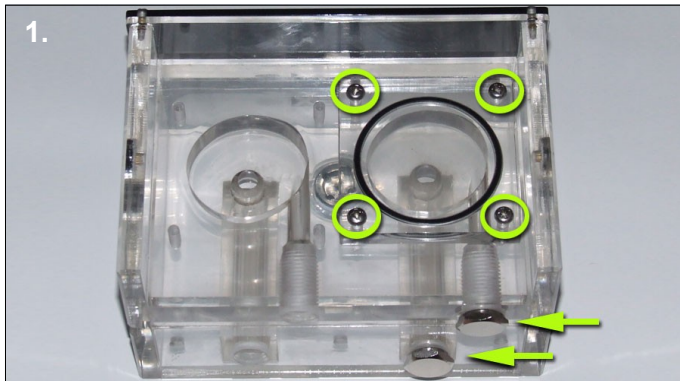

1. Turn the reservoir upside down. If you are using two pumps, remove the blanking plate and two G1/4" plugs.

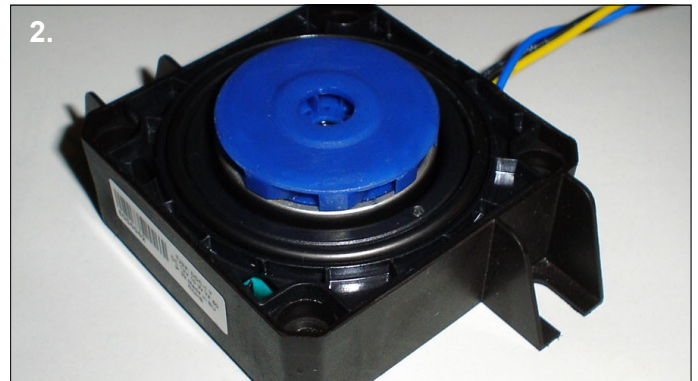

2. Remove the original top from the DDC pump by unscrewing the four screws on the base of the pump. Place the o-ring back onto the pump.

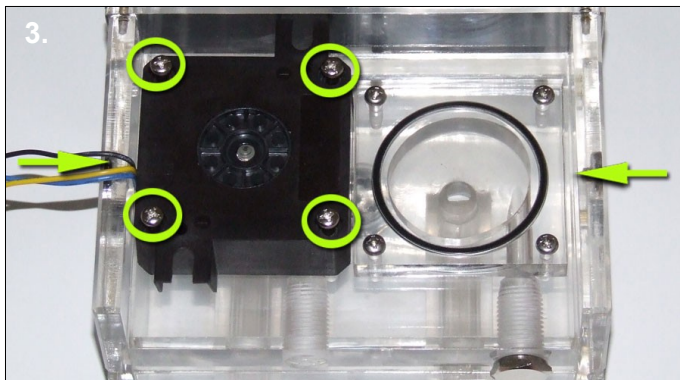

3. Place the pump onto the reservoir making sure that the o-ring stays in place. The pump should be orientated so the wires are on the outer sides of the reservoir. Use the 4 long screws to attach the pump to the reservoir, tightening them until the large o-ring is compressed.

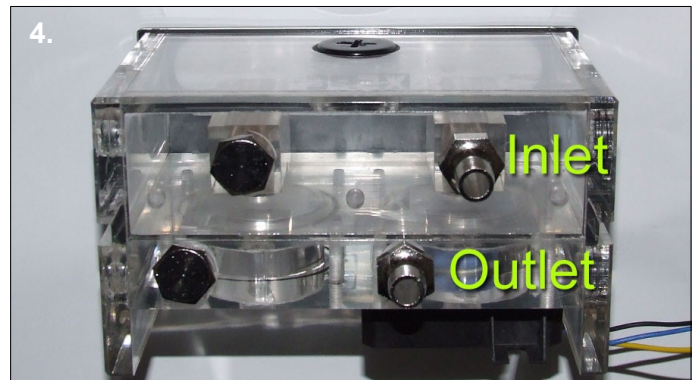

4. Repeat stage 3 on the opposite side if you are using two pumps. Now screw the G1/4" fittings to the inlet and outlet making sure the o-rings are compressed. The pump is now ready to be connected to your other watercooling components and leak tested before being fitted into two 5.25" drive bays.

Pump noise

The pump may make some noise until all the air has been removed from the system, this is normal.

Warning: Do not clean with alcohol