

Technical Details

Tube Material: Glass
 Cap Material: Acetal
 Bracket Material: Aluminium
 170 Dimensions: 241.5 x 85 x 89mm
 270 Dimensions: 344 x 85 x 89mm
 170 Capacity: 410ml
 270 Capacity: 690ml
 Fill cap size: M20
 3x G1/4" Ports
 1x 5mm LED Hole

Pump Details

4 Pin Molex and 3 Pin Tacho Output
 Speed Selector Dial
 Maximum Flow: 1200 lph (12V)
 Maximum Head Delivery: 3.7m (12V)
 Voltage: 8-24V (37W Max)

Box Contents

1x Tube Reservoir/Pump
 1x M20 Cap
 1x G1/4" Plug
 1x 5mm White LED
 4x 6-32 Screws

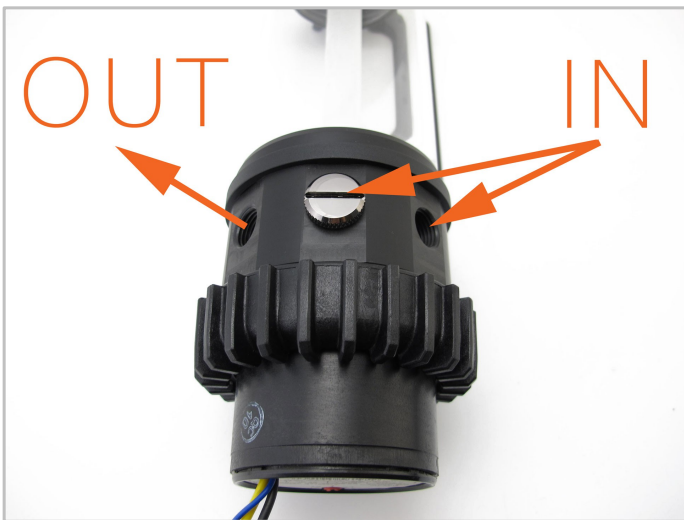

1. The pump has one outlet and two inlets. Attach the G1/4" hose fittings to your ports of choice and use the G1/4" plug to block the unused port..

2. To fill the reservoir use a small coin to undo the fill cap and fill the reservoir to the top of the glass. The fill cap can also be used as an inlet with the use of a M20 to G1/4" adapter. The fill cap cannot be used as an outlet.



3. When fitting the LED, slightly kink the LED wire and push the LED into the hole on the base of the reservoir. You might need to twist the LED slightly until it slots into place.

4. The Photon will mount directly to a radiator without need for case modifications. Use the supplied screws to attach the reservoir to your radiator.

The Photon reservoir can be mounted vertically or horizontally. If mounting horizontally the coolant level must be kept at the maximum.